

20 Series 'Fast Fit' Floor Box - Information and Instruction Sheet



Our individual 20A Series 'Fast Fit' access floor box has been designed to meet the demands of the modern day working environment. Separate removable compartments allow services to be removed whilst the floor box body and lid remain in situ.



Main features

1. Fully configurable with wide range of 3 and 4 compartment accessory plates.
2. Can be prewired with Betatrak® tap-offs.
3. Deeper versions available, depending individual requirements.
4. Quick removal with services fitted.
5. Installation tolerance of $-0/+3\text{mm}$.
6. Fixes to floor thickness of 15mm - 50mm.
7. Optional lockable lid.

Different compartments options available



2 Compartment



3 Compartment



4 Compartment

Dimensions

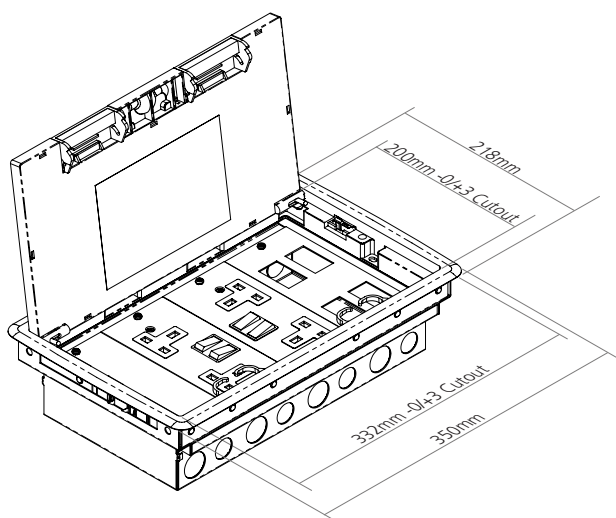

Contents

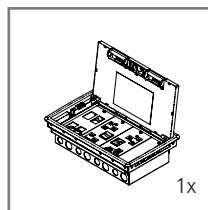



20 Series 'Fast Fit' Floor Box - Information and Instruction Sheet

Instructions - Fast Fit installation

1. Pick a location for the box and make the opening.
2. Prepare the box and get it in position (Fig.1).
3. Press the box firmly into place (Fig.2).
4. For finish floor installation, remove the screws located inside trim (Fig.3).

Instructions - How to remove a floor box

1. If the floor box has locking handles, lift them so they are no longer locking the box in place.
2. Many fast-fit floor boxes allow you to remove them without taking off the lid. If this is the case, simply lift the lid to an open position.
3. Look for the steel clips on either side of the box. Insert a flat-blade screwdriver into the slot in one of these clips (whichever side is easier in terms of whether you're left or right handed) and lever outwards until the clip comes into contact with the moulded trim. Hold in this position (Fig.3).
4. Lift the box out of the floor, using the lid as a handle.

Instructions - Concrete or Screed Floor

1. Position the box as necessary. Set the temporary cover to match the height of the finished floor and make any levelling adjustments.
2. Use screws, nails or wire to secure the box so it won't float when the concrete or screed is poured.
3. Unscrew and remove the temporary cover (sometimes called a mud cap).
4. Run the necessary power cords to the floor box.
5. Reattach the temporary cover.
6. Once the concrete or screed has been poured, set and finished, install any cover plates and/or accessories.

Warning

Do not use this product for any purpose other than which it was designed for.

All electrical cables should be fitted by a qualified or instructed person.

Do not dismantle or remodel the floor box.

Fig.1

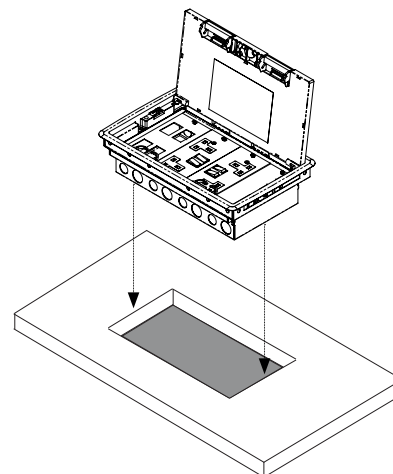

Fig.2

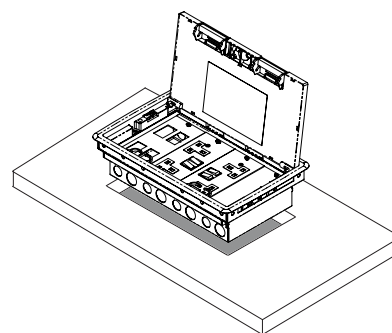
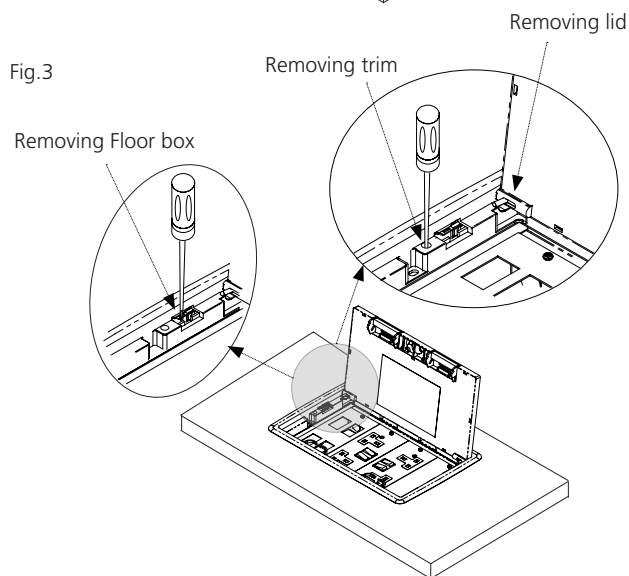

Fig.3



Cleaning, Storage and Maintenance

Cleaning and Maintenance Dry cloth, no abrasives or solvents to be used on the module surface.

Handling and Storage Do not drop or expose to moisture.