

## Air Monitor Arm

### Description

Air is a flat screen monitor arm featuring innovative engineering and contemporary styling. It offers all the benefits you would expect of an adjustable gas lift arm with an extensive range of useful features.

### Cleaning Storage & Maintenance

Routine Servicing	Occasionally rotate and move arm
Service Components	Available to order
Cleaning & Maintenance	Damp cloth, no abrasives or solvents to be used on the cosmetic surfaces.
Handling & Storage	Do not drop or expose to moisture

### Warning

Ensure desk surface / partition / is suitable to take the weight of the arm

Do not use this product for any purpose other than the one it was designed for

Hold monitor tightly when making any adjustments

Care should be taken to avoid trapping fingers

Do not attach monitor before assembling the arm

Do not dismantle or remodel the arms

Maximum weight supported by monitor arm is 8kg

Minimum weight supported by monitor arm is 2kg

### Additional Features

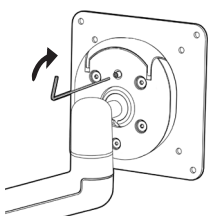

#### Security Screw

Tighten the security screw to lock the monitor and prevent removal. Use a 1 x 2mm allen key for this.

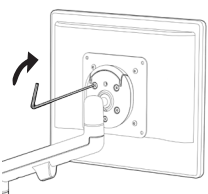

#### Weight Adjustment

Heavy monitors may require the 4 screws on back of the head to be tightened further to strengthen resistance. Max Weight 8kg. Minimum Weight 2kg.

### Contents (depending on selection)

- x1 Air Arm
- x1 Vesa Plate
- x4 Screws

**NB** Please note that allen keys are not supplied. You will need 4 x allen keys (1 x 2mm, 1 x 2.5mm, 1 x 4mm & 1 x 5mm)

#### Fixing Options

- x1 C-Clamp
- x1 Through Desk
- x1 Slatwall Bracket

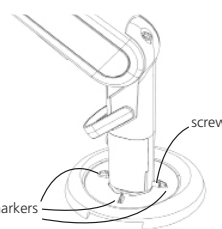
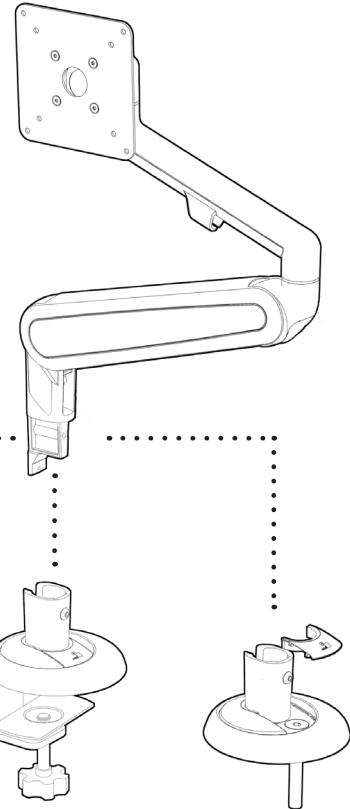

#### Limit Rotation

You may limit the rotation at either 90° or 180° if desired. Using an 1 x 2mm allen key, tighten or loosen the screw in the base to lock the rotation between the set markers.



#### Resistance

To counterbalance the weight of the monitor use an allen key to either increase or reduce the resistance.

## Air Monitor Arm

**1 Choose a Fixing Kit**

**Slatwall**  
Attach the slatwall fixing kit to the slatwall using an allen key.

**C-Clamp**  
Place clamp onto the edge of the desk and tighten.

**Through Desk**  
Place through desk base on desk and screw into place.

**2**

Before installing the arm you may limit the rotation at either 90° or 180° if desired. Using an 1 x 2mm allen key, tighten or loosen the screw in the base to lock the rotation between the set markers.

**3**

Bring the arm to the base and slide in from behind into the cup. Once in place, using the 1 x 4mm allen key lock arm into cup. You then clip the plastic cover over the base for a stylish finish.

**4**

Attach the VESA plate to your monitor using the x4 screws provided. Max Weight 8Kg per head. Minimum weight is 2Kg.

**5**

Open the lever on the head of the arm.

**6**

Hook VESA onto the head of the arm and push firmly down.

**7**

Once in place, close the lever on the head to fix the monitor in place. If the monitor droops, then use a 1 x 2.5mm allen key to increase resistance by tightening the screws on the back of the head.

**8**

Hold the arm horizontally to adjust the resistance of the gas strut to counter balance the gas screen. Turn a 1 x 5mm allen key clockwise to increase flexibility and counter clockwise to tighten.

**9**

Once the arm is in place, clip on the cable management clips