

Porthole II power and USB charging module

This version of Porthole has been designed to include our dual port USB charger, which is capable of charging a wide range of devices including the simultaneous charging of two Apple devices.

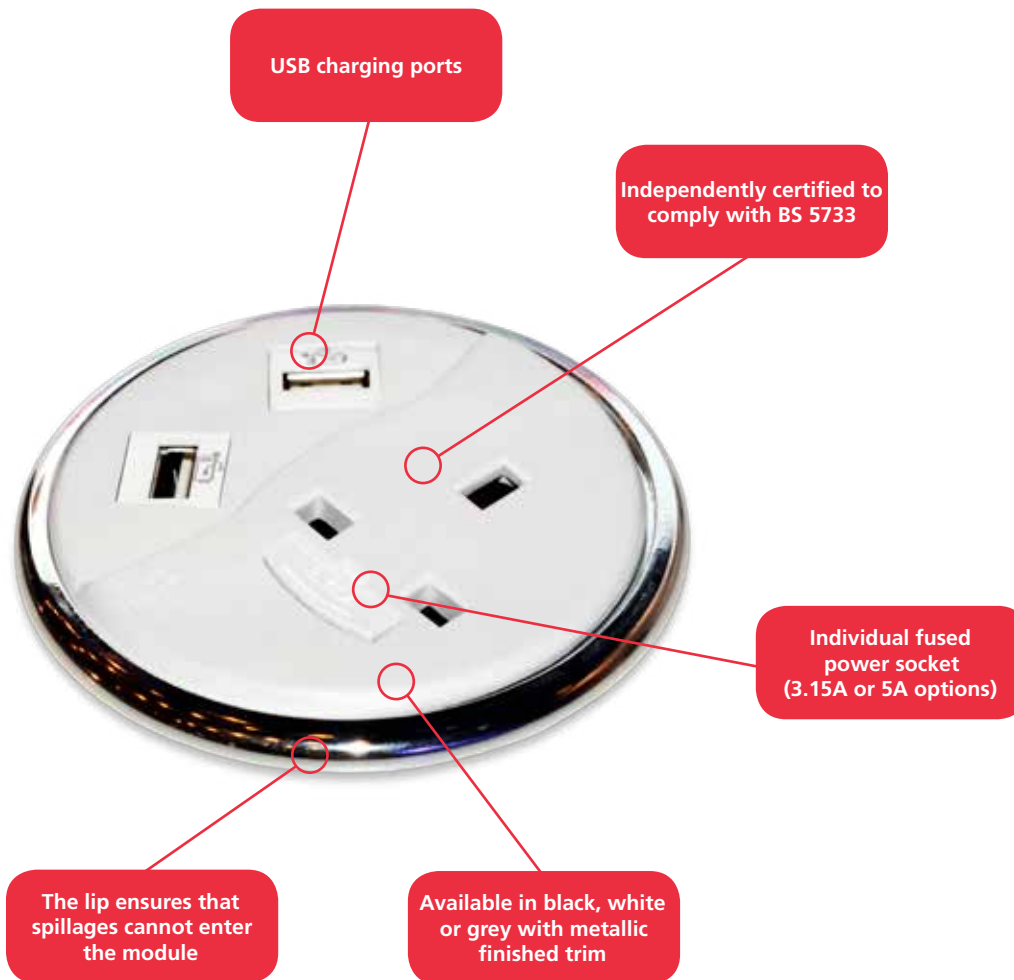

- Complies with the latest charging standard (BS EN 62684:2010 Interoperability specifications of common external power supply (EPS) for use with data-enabled mobile telephones)
- Dual port USB charger capable of charging a wide range of devices including the simultaneous charging of two Apple devices
- Two independent USB charging ports, which can be used at the same time
- Powered from adjacent power socket so no additional wiring is required
- The charger is compatible with our full range of in desk and on desk modules

Code	Colour	Description
90CP01BGST	Black	1 x Power Socket
90CP01GGST	Grey	Power socket 3.15A individually fused with 2 port USB charger, 1m mains cable to 3 Pole connector
90CP01WGST	White	

Note: CMD cannot accept any responsibility or liability for providing category 6 performance in products supplied. We will however fit category 6 specification components where specified.

Fuses only accessible after removal of equipment plug. Lead lengths shown will be the conductor length and not the distance from the end of the module to the plug. For example, a 3m prewired power lead will be approximately 2.875m as 125mm will be internal for the termination. This is also applicable for data leads.

HDMI: CMD cannot accept any responsibility or liability for providing HDMI performance in products supplied over 10m in length.