

This installation guide is intended to be used specifically with the earth types shown below. Ensure the colour of the tap-offs are correct for the type to be fitted to the powertrack prior to installation.

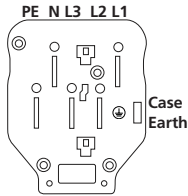
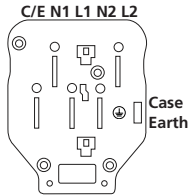

Dual Circuit green tap-off

3 Phase blue tap-off

Note:
Standard Earth (white) and Clean Earth (red) tap-off plugs can be attached to the Dual Circuit track in addition to the Dual Circuit tap-off plugs (green).

Typical floor layouts

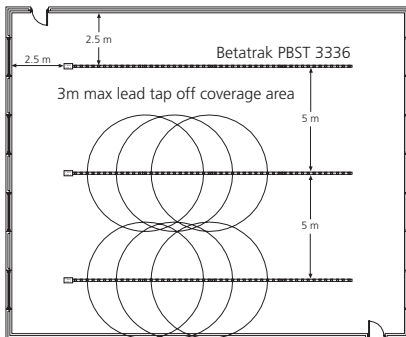

Powertrack
3m tap-offs provide full coverage when powertrack is laid out on 5m centres.

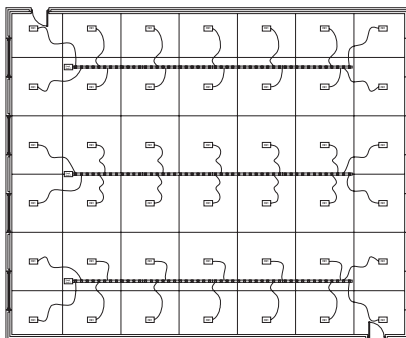

Floor Boxes
Typical layout: 1 floor box for every 10m².

Prepare the site

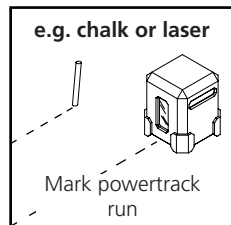
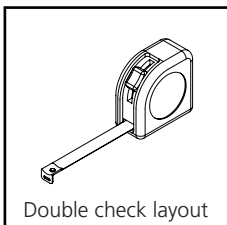
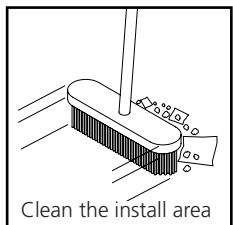

Feed unit connection (feed unit to powertrack)

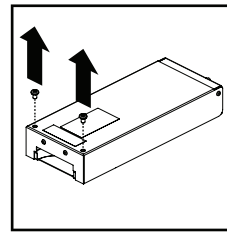

Remove the 2x screws on the feed unit cover and put to one side.

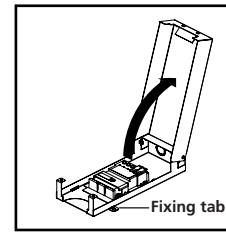

Lift up the feed unit cover as shown to gain access to the terminals.

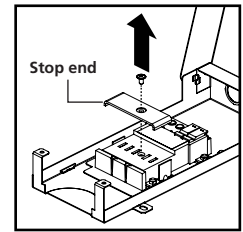

Remove 1x No8 x 1/2" posi flanged screw and stop end. This screw is to be used later.

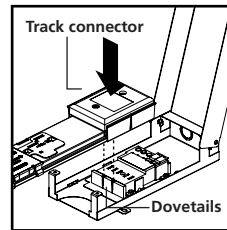

Align dovetails on the connectors and push down firmly. Do not hammer into place.

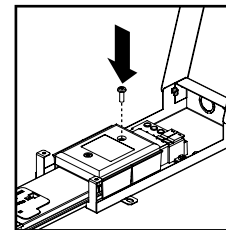

Fix the track in place with the supplied 1x No8 x 1" posi pan self tapping screw.

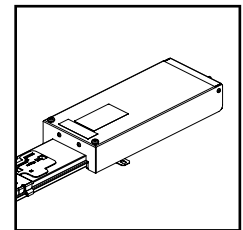

With the powertrack and feed fixed to the floor close the feed unit cover.

Track length connection (track to track)

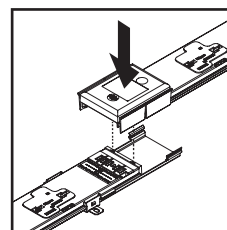

Align dovetails on the connectors and push down firmly. Do not hammer into place.

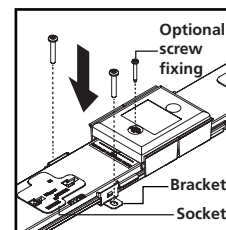

Secure the powertrack with a bracket placed between last socket and powertrack connector.

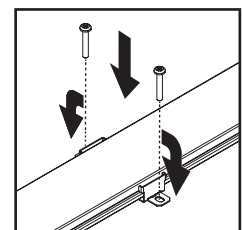

Position intermediate brackets as shown, flip down tabs and screw fix to floor.

Stop end

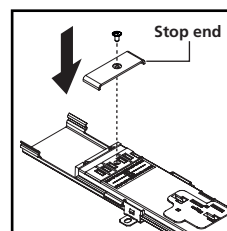

Fix the stop end to the end of the last track piece with 1x No8 x 1/2" posi flanged screw.

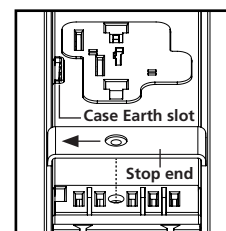

Ensure the hole in the stop end is closest to the side of the powertrack with the Case Earth slot.

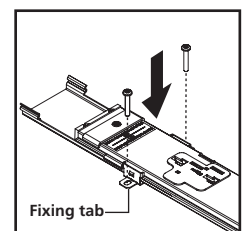

Screw the fixing tabs to the floor as shown.

Feed wiring instructions

Wire colour key:  Live Brown  Neutral Blue  Earth Green/Yellow

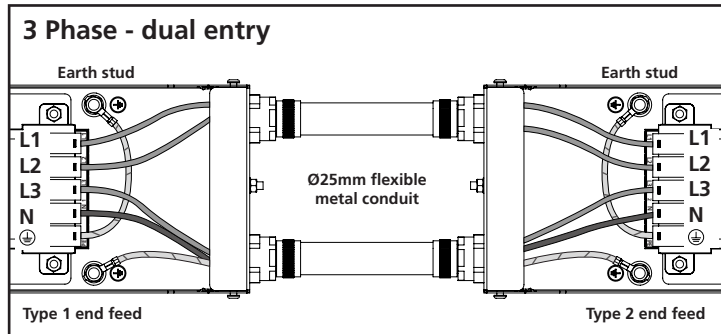
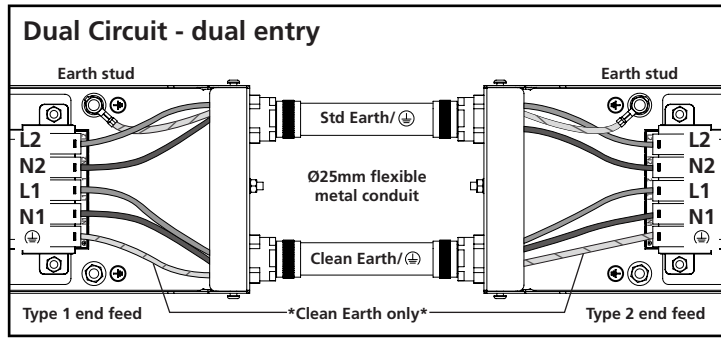

Flexible corners (supplied separate to feed and powertrack)

- Flexible corner kits consisting of a Type 1 and a Type 2 feed end must utilise a suitably rated cable to meet the rating of the protective device at the origin of the circuit.
- The installation method of the cable and type utilised between the Type 1 and Type 2 feed ends must be selected to suit the external influences of the installation.
- You must follow the correct wiring arrangement appropriate to the Betatrak type to achieve phase and earth connection requirements.

Flexible corners - dual feed

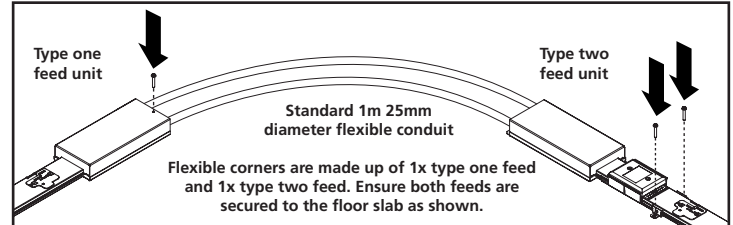

Tap-off engagement/release

****WARNING****
An unterminated tap-off **MUST NEVER** be connected to a live track. Provided that it is off load, a terminated tap-off may be removed/inserted into a live track. Conduit must be bonded to Earth.

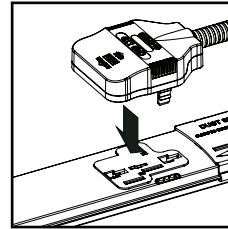

Align tap-off pins with slots on socket. Push down to engage.

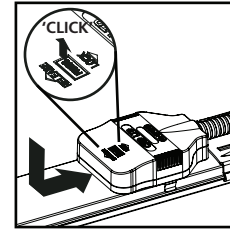

Press down and push backwards until button clicks upwards to lock.

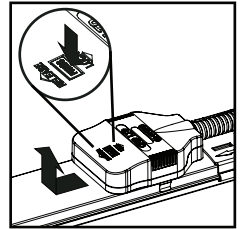

To remove, press button to disengage. Push forwards and lift up to remove.

Earthing ring/tag (not supplied by CMD)

The feed end has the ability to accept a standard M25 SWA Earthing ring/tag with fixing points at 36.5mm.

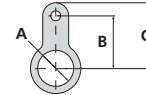

A = M25
B = 36.5mm
C = 45.5mm
Thickness = 1.5mm

Additional information

Safety

- Installation is to be carried out in accordance with relevant Health & Safety regulations and only to be carried out by a skilled or competent person.
- The product should be installed to comply with the relevant national standards and be inspected and tested prior to being put into service (in the UK BS 7671 Wiring Regulations).
- Isolate the supply before installation or repositioning. Any locking mechanisms must be used and fully engaged.
- Incorrect use could lead to risk of electrocution.
- Product to be used only for the intended purpose of distributing power in a commercial environment.
- Do not misuse, dismantle or re-configure the product because doing so will invalidate the warranty.

Standards

- Refer to the Declaration of Conformity.

Further guidance

- Fuse replacement only to be carried out by a skilled or competent person.
- Should the supply cable need replacing, contact CMD.

Product care

- Clean using a dry cloth. No abrasives or solvents to be used on the product.
- Do not drop or expose to moisture.

