

# On Desk USB Power

Chip is a 4A USB charging module set to revolutionise the way we use on desk power. With more and more devices using USB the demand for traditional sockets on the desk is falling. This stylish and fully integrated module simply connects to your under desk power using a Wieland or plug to offer 2 USB power supplies capable of charging all leading phones and tablets.

## Chip USB Power Module

power modules

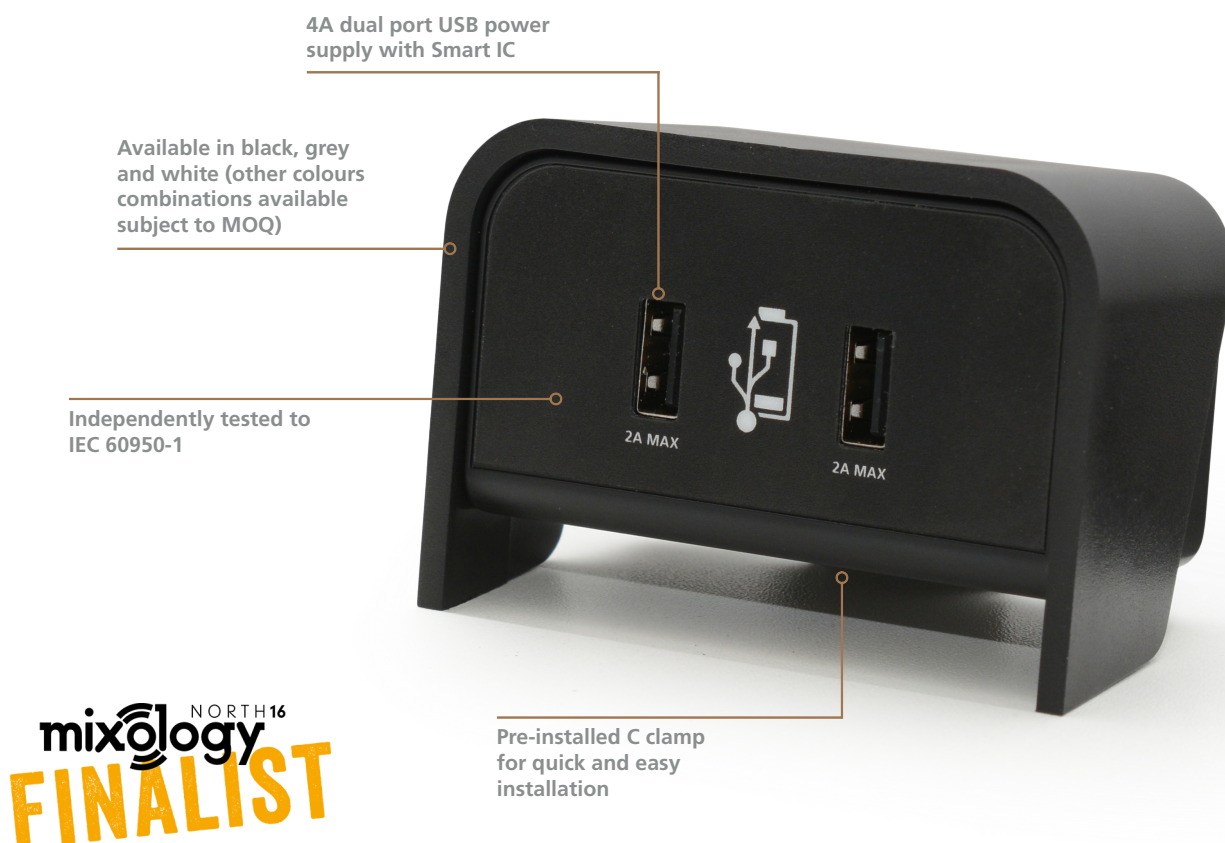

### Features

- Plastic moulded body available in black, grey or white
- Contrasting body and fascia graphics available subject to minimum order quantities
- Fully integrated twin port 4A USB charger providing max two amp power supply at each port
- Supplied as standard with a 1m mains lead to 3 pole connector or UK plug
- Tested to IEC 60950-1
- Fixes to desk surface using a Chip C clamp



### Manage your energy

Connect to Footprint to allow energy to be monitored and controlled with the Footprint dashboard. See page 73 for more details.

Cables: White and grey modules are supplied with white cables and black modules are supplied with black cables.



Black



Grey

This new module is available in black, grey and white as standard but has been designed to present a number of options for contrasting housing, fascia graphic and outer cover subject to minimum order quantities and lead times. For more information please speak to a member of our sales team.

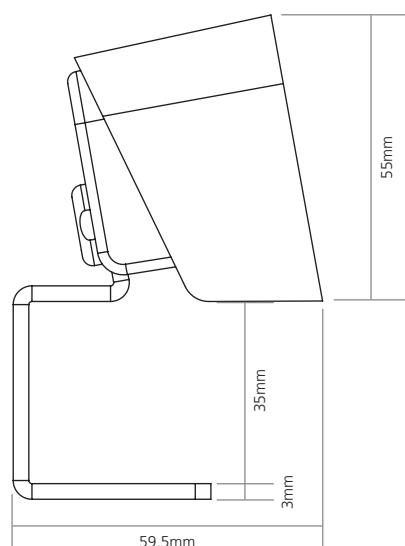
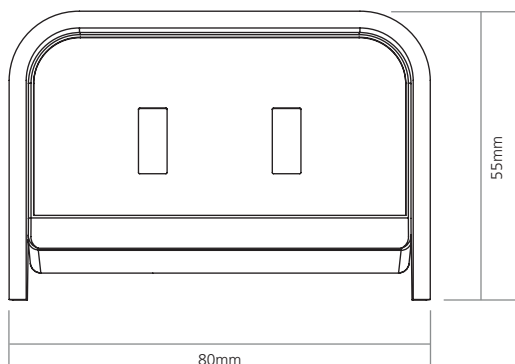

Note: Chip comes complete with bespoke C clamp fixing for desk thickness 15mm to 35mm.

## On Desk USB Power



White



Grey with white fascia



White with black fascia

Other colour combinations are available. Please call for details.

Code	Colour	Description
7500001	Black	2 x Twin port 4Amp USB charger 1m mains lead to 3 pole connector
7500002	Grey	2 x Twin port 4Amp USB charger 1m mains lead to 3 pole connector
7500003	White	2 x Twin port 4Amp USB charger 1m mains lead to 3 pole connector