

This latest version of PortHole has been designed to support a range of UK and international sockets and comes complete with integral 4A USB power supply. The 2 port USB power supply, which is capable of charging all leading mobile phones and tablets, is designed to share the power when two devices are connected but can deliver a maximum 4A to a single USB socket when only one device is connected.

PortHole UK and International Power and USB Charging Module

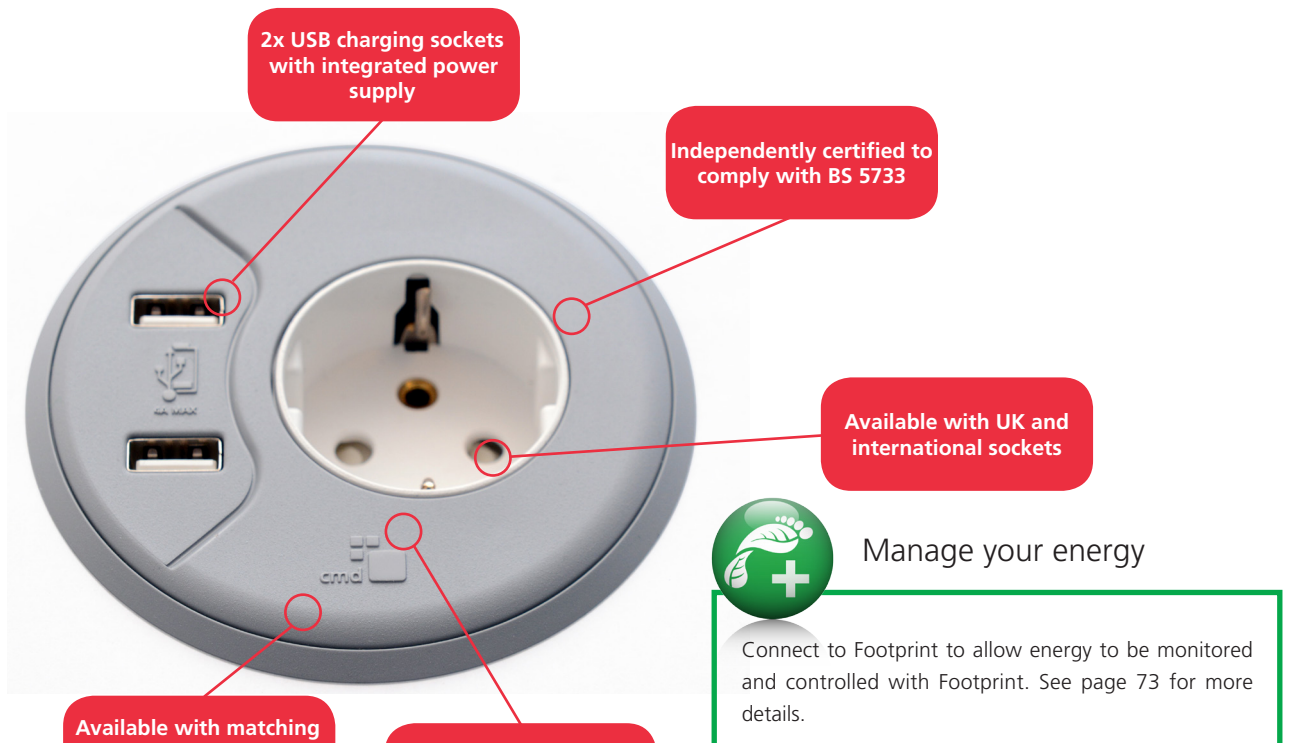

Features

- Available with a choice of black, white and grey plastic fascia with matching trim
- A choice of UK or a range of international sockets
- Unit complies with BS 5733
- All standard options are supplied with a 1m mains lead to 3 pole connector
- Requires a separate mains lead if connected directly to a wall or floor socket
- Easy to retrofit, incorporates an under desk, hand tightened barrel nut to fix unit in place
- Fully integrated 4A USB power supply
- Designed to fit any desk thickness between 12mm and 42mm

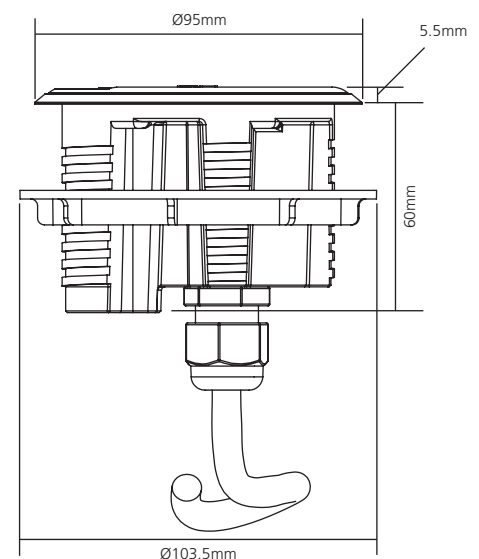

Cables: White and grey modules are supplied with white cables and black modules are supplied with black cables.

Data Cables: CMD cannot accept any responsibility or liability for providing category 6 performance in products supplied. CMD cannot accept any responsibility or liability for providing HDMI performance in products supplied over 5m in length.

Fuses: Only accessible after removal of equipment plug. Lead lengths shown will be the conductor length and not the distance from the end of the module to the plug. For example, a 3m prewired power lead will be approximately 2.875m as 125mm will be internal for the termination. This is also applicable for data leads. Data fascias may be subject to colour change.

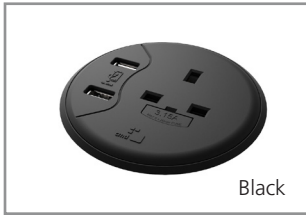

Code	Colour	Description
90FC01BGST	Black/Black Surround	1 x UK Power Socket 1 x 2 Port 4A USB Socket
90FC02GGST	Grey/Grey Surround	Power socket 3.15A individually fused with 1m mains lead to 3 Pole connector
90FC03WGST	White/White Surround	
90FC04BGST	Black/Black Surround	1 x UK Power Socket 1 x 2 Port 4A USB Socket
90FC05GGST	Grey/Grey Surround	Power socket 5A individually fused with 1m mains lead to 3 Pole connector
90FC06WGST	White/White Surround	
90FC07BGST	Black/Black Surround	1 x Schuko Power Socket 1 x 2 Port 4A USB Socket
90FC08GGST	Grey/Grey Surround	Power socket shuttered with 1m mains lead to 3 Pole connector
90FC09WGST	White/White Surround	

Note: Other international socket options are available so please discuss with a member of our sales team.

PortHole Wireless Charging Module

This award winning version of PortHole takes charging to the next level - wireless! It is ideal for adapting an 80mm cable hole or for upgrading your existing PortHole and PortHole II modules.

Simply place your wireless induction charging compatible device on the charger. A beep will acknowledge the connection, LED's will illuminate around the charger's perimeter and charging will commence.



Wireless charging surface

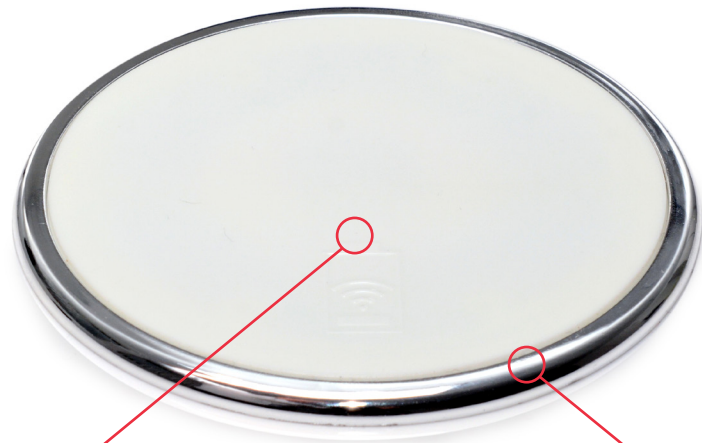

Wireless charging surface

Available with silver or matching surround to deflect spillages

the **ELECTRICAL**
Industry awards
WINNER 2014

Code	Colour	Description
90WP01BGST	Black/Silver Surround	1 x Wireless charging module
90WP01GGST	Grey/Silver Surround	1m mains cable to 3 Pole connector
90WP01WGST	White/Silver Surround	