

### Thin Floor Support Kit

When laying thin/flexible flooring materials such as carpet or vinyl, this kit can be used to give additional support to the flooring material around the grommet hole.

Thin Floor Support Kit

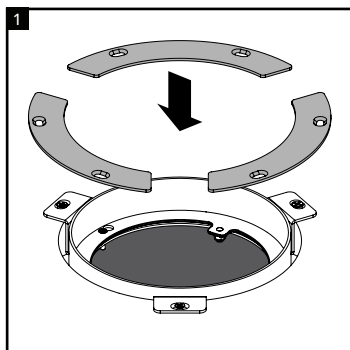
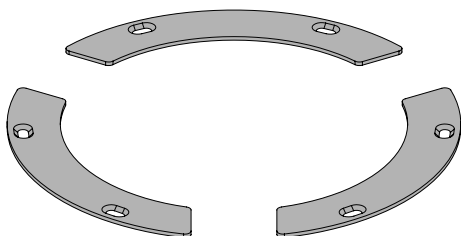

Lay the segments of the Thin Floor Support Kit around the installed grommet floor mount.

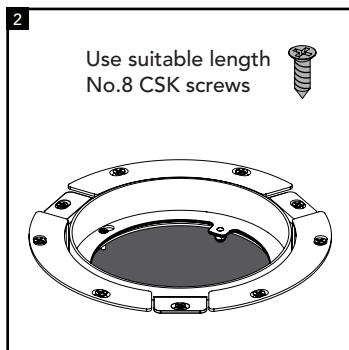

Secure each segment to the floor using 2x suitable length No.8 CSK fixing screws (screws not supplied.)

### Floor Hole Cover

If the floor hole/installed floor mount are to be left exposed for any period of time, (for example because the flooring/grommet installation is scheduled later in the programme of works) this accessory can be used to temporarily cover the hole until the next stage of installation.

Floor Hole Cover

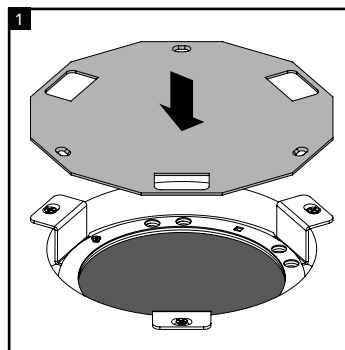
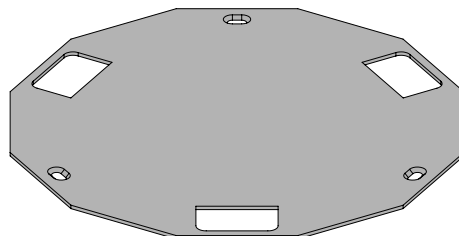

Lay the Floor Hole Cover over the installed grommet floor mount, ensuring that the rectangular cut-outs locate on the mount brackets.

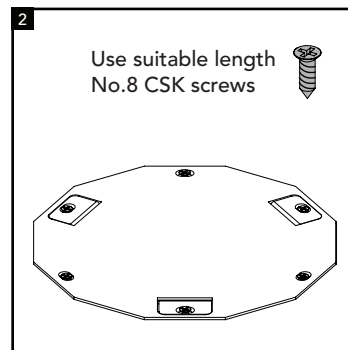

Secure the cover using 3x suitable length No.8 CSK fixing screws (screws not supplied.)

### Additional information

#### Safety

- Installation is to be carried out in accordance with relevant Health & Safety regulations and only to be carried out by a skilled or competent person.
- It is recommended that this product is not installed in high traffic areas.
- The product should be installed to comply with the relevant national standards and be inspected and tested prior to being put into service (in the UK BS 7671 Wiring Regulations).
- Isolate the supply before installation or repositioning. Any locking mechanisms must be used and fully engaged.
- Incorrect use could lead to risk of electrocution.
- Ensure to replace the lid after use.
- Do not misuse, dismantle or re-configure the product because doing so will invalidate the warranty.

#### Product care

- Clean using a dry cloth. No abrasives or solvents to be used on the product.
- Do not drop or expose to moisture.